

Housing Tour

1) CHAMPIGNON

Thallon and Edrington Architects, Threshold Architects and Landscape Architects
Coburg Road North, after Bailey Lane go left on Cal Young Road, left on Spyglass Drive

An environmentally sensitive cluster housing development in a wooded setting with two distinct housing types, alley homes and cedar shake cottages.
Compact, high-end housing with mature shared landscaping.

2) CRESCENT VILLAGE Contact Sadie Dressekie at (541) 344-5500, mark@arlie.com.
Head north on Coburg Road past Beltline Line and Costco. Turn right on Crescent Ave and proceed half a mile. Site is on the north side of Crescent Ave and it will be very obvious. Please park on Shadow View Dr but on the south side of Crescent Ave, NOT in the construction area. Our meeting point will be at the first model Townhome near Crescent Drive <http://crescentvillagetownhomes.com/>

3) SHELDON VILLAGE

Bergsund Delaney Architects, Andrea Bishop manager, 461-0341
From Champignon, go east on Cal Young, left on Willakenzie, right at Oasis Plaza shopping center. From Coburg Road, west on Willakenzie, left at Oasis Plaza. The project is south of the Oasis Plaza.

Dense affordable housing units create an intimate urban village that features garden lanes. The "island" complex connects to shopping, parks, schools and public transportation.

<http://www.bdarch.net/Portfolio/Sheldon/Sheldon.htm>

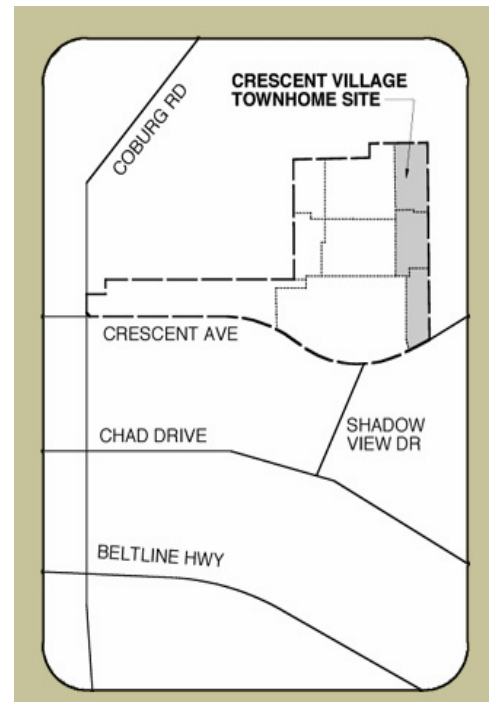

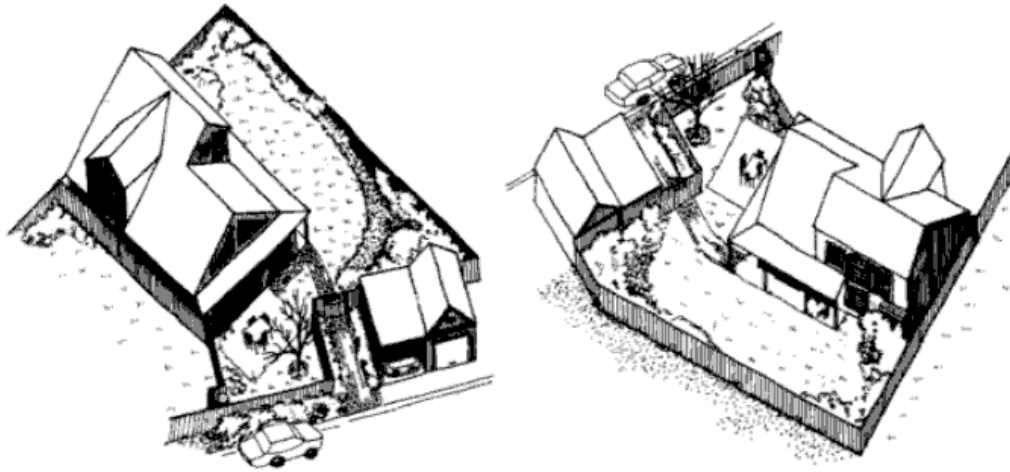

Champignon: site plan (top) & southern exposure house with side yard



Crescent Village Townhomes